

** Please ensure thorough unpacking of all components and carefully compare them against the provided parts list. Prior to commencing assembly, carefully review all accompanying instructions. It may be necessary to make adjustments to pre-assembled components during the assembly process.*

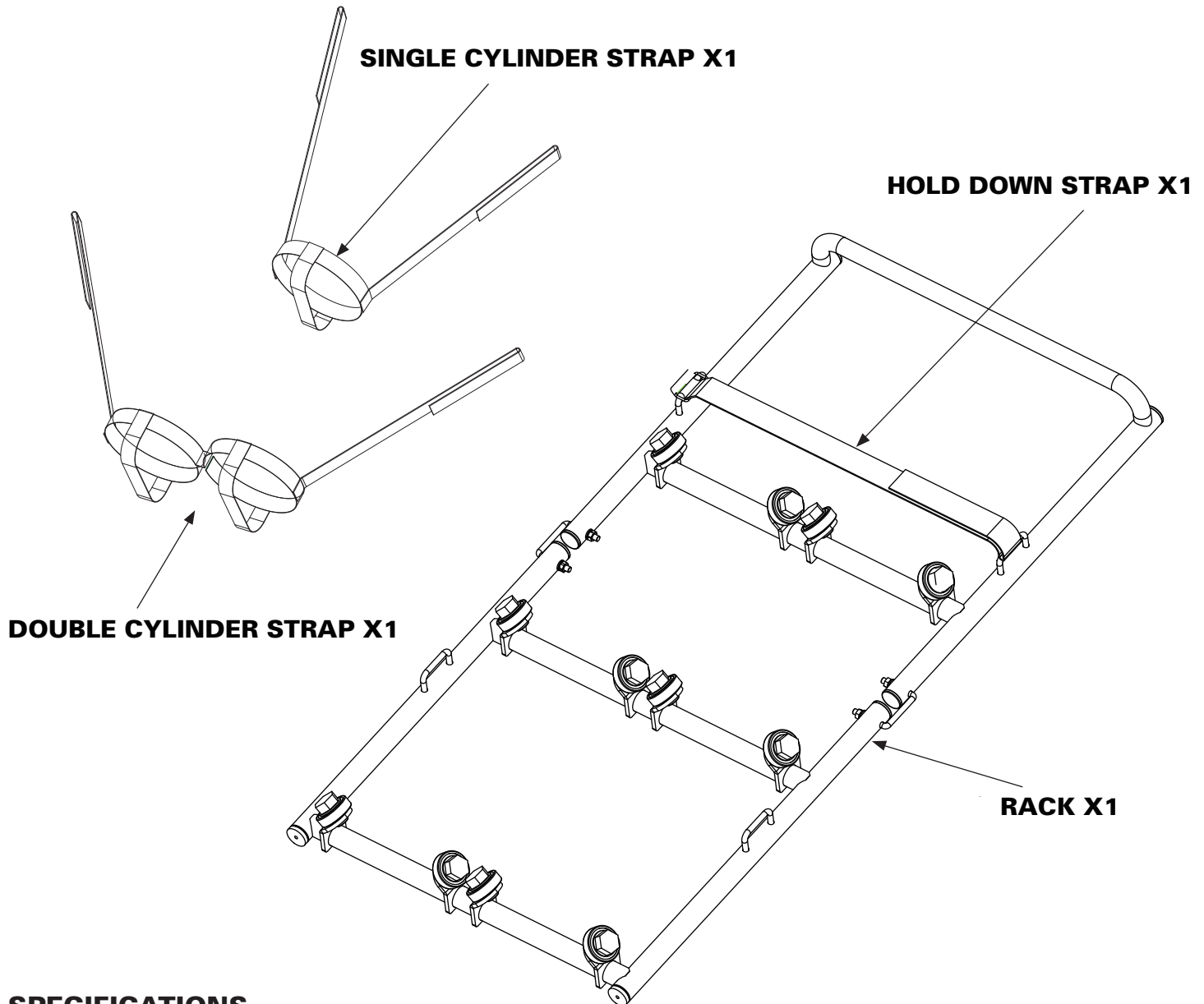

SPECIFICATIONS

PN	Dimensions	For Cylinder Diameter	For Cylinder Height	Load Capacity	Weight
GCR240	50.6" x 23.3" x 3.72" 1286 x 592 x 94.5 mm	8.6" ~ 9.4" 220 ~ 250 mm	45" ~ 59" 1,140 ~ 1,500 mm	330 lb 150 kg	31.13 lb 14.15 kg

HOW TO USE

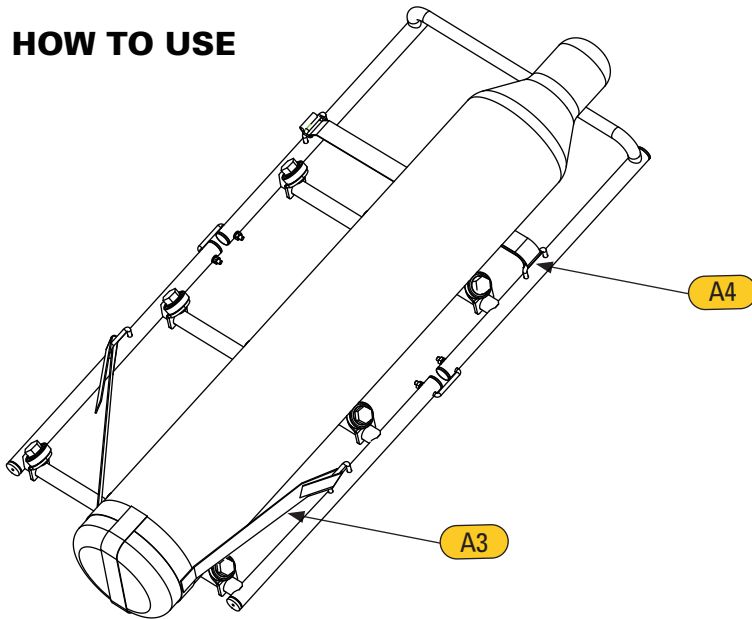

TRANSPORT ONE GAS CYLINDER:

1. Slide the cylinder onto either the left or right side of the rack, using the rollers, until it is fully in place.
2. Secure the cylinder on the Rack using the Hold Down Strap (A4).
3. Slide the Single Cylinder Strap (A3) to the bottom of the cylinder and fasten it to the handles on the Rack.

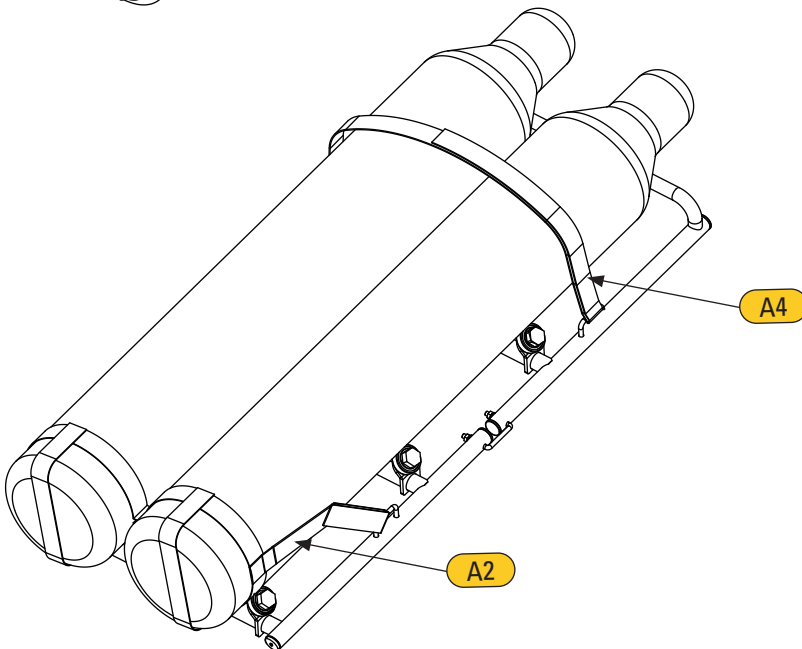

TRANSPORT TWO GAS CYLINDERS:

1. Slide two cylinders onto the left and right side of the rack, using the rollers, until they are fully in place.
2. Secure both cylinders on the Rack using the Hold Down Strap (A4).
3. Slide the Double Cylinder Strap (A2) to the bottom of the cylinders and fasten it to the handles on the Rack.

MAINTENANCE

Regularly inspect Cylinder Transport Rack for any signs of damage or wear. Keep moving parts lubricated and clean. Ensure all safety features are functioning properly.

SAFETY

Always wear appropriate personal protective equipment (PPE) when operating the Cylinder Cargo Rack. Follow proper lifting techniques to prevent injuries. Ensure cylinders are securely restrained before transport. Be mindful of surroundings and potential hazards.

LIMITED WARRANTY

Each STRONG HAND TOOL product is warranted to be free from defects in material and workmanship. Return to place of purchase for a replacement if warranty applies.