

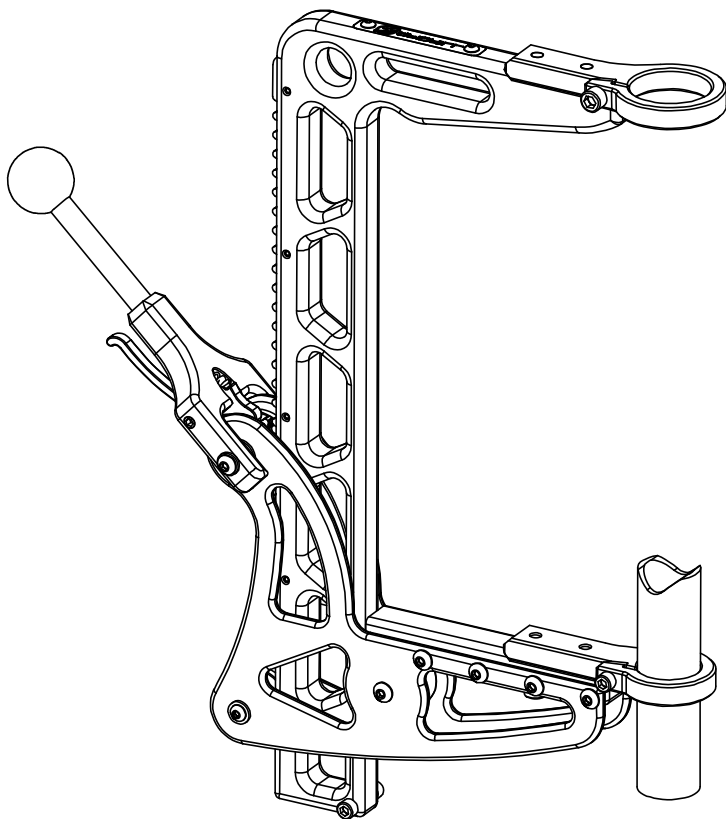

USER MANUAL

Rapidrill 303101



Thank you for choosing Rapidrill. We appreciate the trust and confidence you have placed in Rapidrill on the jobsite and in your shop. We have developed a quality and dependable tool which enhances user control, productivity and safety. Visit us online at www.rapidrill.com and let us introduce you to a new world of drilling!

Contents

- Definitions 4**
- Safety Guidelines 6**
- Safety 6**
 - WORK AREA SAFETY6
 - PERSONAL SAFETY6
 - MECHANICAL SAFETY6
 - END-MILL, BIT SAFETY6
- Warranty 8**
 - LIMITED LIFETIME WARRANTY8
 - INTENDED USE8
 - LIMITATION OF LIABILITY8
 - APPLICABLE LAW8
- Package Contents 9**
- Setup 9**
 - ATTACHING DRILL9
- Operation 10**
 - GETTING TO KNOW RAPIDRILL 10
- Maintenance 13**
 - ANODIZED COATING 13
 - ZINC-PHOSPHATE COATING 13
 - OTHER COMPONENTS 13

© 2016 Rapidrill, LLC All rights reserved.
Printed in the USA.
Made in the USA
US Patent Protected 4,870,141
Rapidrill, and the Rapidrill Logo are trademarks of Rapidrill, LLC.

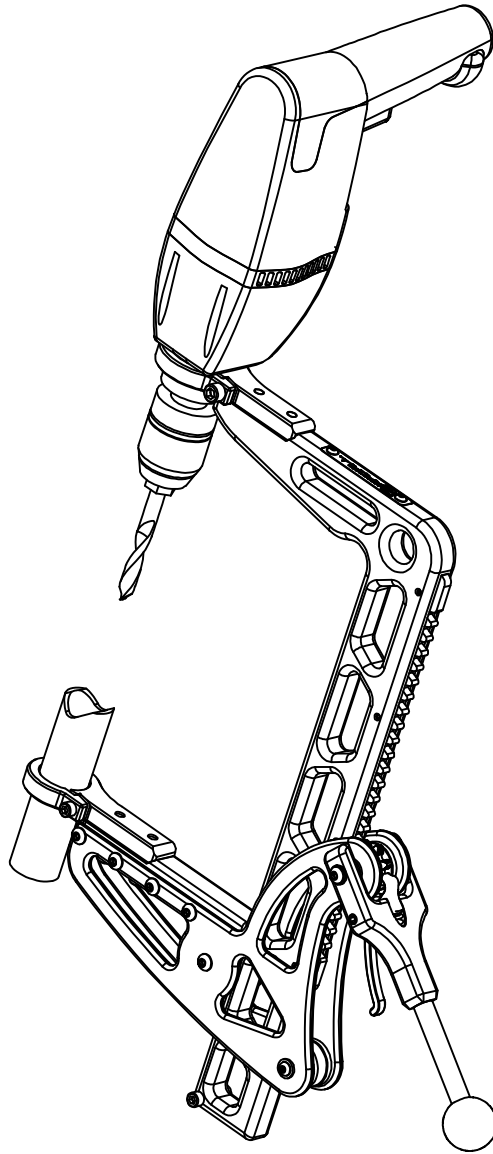

Questions, Problems, Missing Parts?

Rapidrill, LLC.
1.855.993.7455
www.Rapidrill.com
support@rapidrill.com

Please contact us at 855.993.7455 for further assistance.

Definitions (See opposing page for numbered definitions.)

Rapidrill. Apparatus which attaches to an electric drill to aid in drill bit penetration.

1. **Lever.** The appendage of the Rapidrill with which the user applies auxiliary force to the drill bit.
2. **Spine.** The L-shaped truss structure in which the Carriage rides.
3. **Carriage.** The rolling assembly comprising of several sub-components with which the Rapidrill is operated.
4. **Gear Dog.** The tooth portion of the Carriage which engages and actuates the gear for travel of the carriage upon the spine.
5. **Gear Dog Lever.** The point at which the user engages and disengages the Gear.
6. **Gear.** The pinion portion mated to the rack mounted on the spine which facilitates carriage movement.
7. **Drill Clamp.** The mounting portion of the Rapidrill which accepts an electric drill body.
8. **Pipe Clamp.** The mounting portion of the Rapidrill carriage which accepts the pipe.
9. **Pipe.** The opposing portion of the Rapidrill carriage which is placed against the opposite side of the workpiece being drilled.
10. **Fastener.** The screw components which a user mounts, tightens or loosens on the clamp components of the Rapidrill.
11. **Drill.** An electrically powered tool which provides the rotary motion to drive a drill bit for penetration of the workpiece.
12. **Drill Collar.** The mounting point on an electric drill that accepts the Rapidrill attachment in place of a standard auxiliary drill handle.
13. **Drill Body.** Describes the portion on which the drill collar is positioned.
14. **Drill Chuck.** The portion of the drill which accepts a drill bit.
15. **Drill Bit.** The sharpened tool which is rotated during penetration of a workpiece.

Auxiliary Drill Handle. The accessory a standard drill is designed to accept as an additional gripping point for drilling.

Backlash. The dangerous rotation created when the drill bit motion is suddenly transferred to the drill body during binding.

Binding. The sudden stopped motion of a penetrating drill bit caused by improperly managed force being applied to the drill bit.

Drilling. The rotary motion of a drill bit in the act of workpiece penetration.

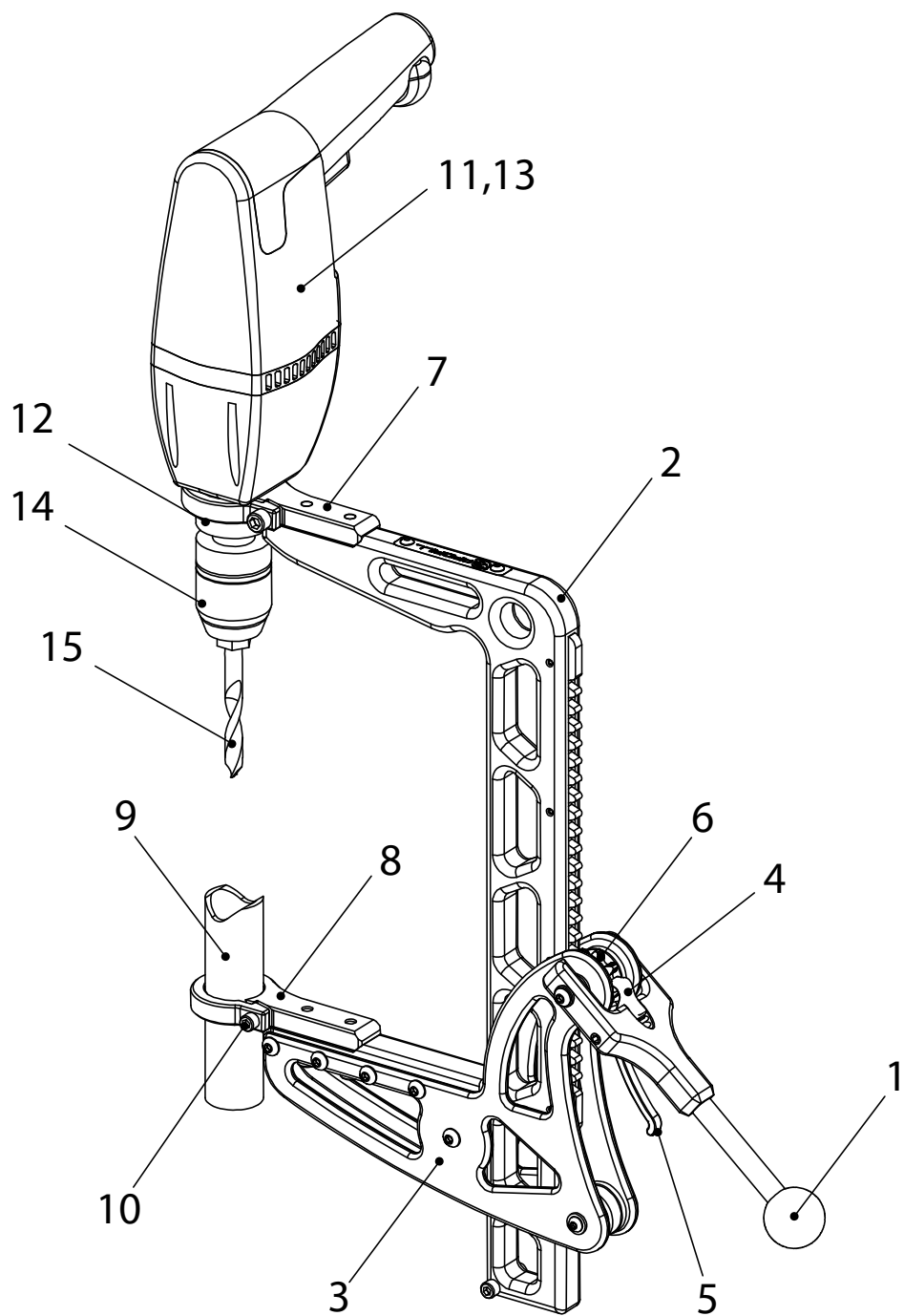

Please contact us at 855.993.7455 for further assistance.

Safety Guideline Definitions

Danger:

Indicates an imminently hazardous situation which, if not avoided, will result in death or serious injury.

Warning:

Indicates a potentially hazardous situation which if not avoided, could result in death or serious injury.

Caution:

Indicates a potentially hazardous situation which if not avoided, may result in minor or moderate injury

Note:

Indicates a practice not related to personal injury which if not acknowledged, may result in property damage.

Safety

WORK AREA SAFETY

1. Keep your work area clean and well lit. Ensure floors are not slippery from wax or dust.
2. Do not operate power tools in an explosive atmosphere, such as in the presence of flammable liquids, gases, or dust. Power tools create sparks which may ignite the dust or fumes. Keep bystanders, children, and visitors away while operating tools. Distractions can cause you to lose control.

PERSONAL SAFETY

3. Use safety equipment. Always wear eye protection with side shields when operating power tools. Safety glasses, dust mask, nonskid safety shoes, hard hat, or hearing protection must be used for appropriate conditions.
4. Stay alert when operating a power tool. Do not use the tool while tired, or under the influence of drugs, alcohol, or medication.
5. Do not wear loose clothing or jewelry. Contain long hair. Long hair, loose clothing, jewelry, or gloves can be caught in moving parts.
6. Keep proper footing and balance at all times. Proper footing and balance enables better control of the tool in unexpected situations.
7. Do not use while standing on ladder or unstable support.
8. For further information on the safe use of power tools, we advise you to obtain a copy of OSHA's hand and powertool standards, or visit <https://www.osha.gov/SLTC/hand-powertools/standards.html>

MECHANICAL SAFETY

9. Beware of pinch points. This mechanical apparatus compounds forces applied and can increase the risk of injury. Exercise necessary precautions during use. Keep hands, feet and other body appendages away from pinch points.

10. During operation keep hold of the apparatus and attached power tool until the power tool comes to a complete stop. Failure to maintain operating stance & control can cause severe personal injury and property damage.

END-MILL, BIT SAFETY

11. Adhere to proper chip load and coolant supply to extend the life of the tool. Failure to observe proper feed rates and speeds can result in reduced tool life and or breakage, which can result in property damage or personal injury.

! WARNING:

Hearing Protection is Recommended. Hearing Protection should be used when the noise level exposure equals or exceeds an 8 hour time-weighted average sound level of 85dBA.

! WARNING:

Do not attempt to modify this tool or create accessories not recommended for use with this tool. Any such alteration or modification is misuse and could result in a hazardous condition leading to possible serious personal injury.

! WARNING:

Operating any power tool can result in foreign objects being thrown into your eyes, causing severe eye damage. Before beginning operation, always wear safety goggles, safety glasses with side shields or a full face shield when needed. Always use eye protection marked to comply with ANSI Z87.1.

! WARNING:

Avoid Prolonged Exposure to Vibration. Pneumatic tools can vibrate during use. Prolonged exposure to vibration or very repetitive hand and arm movements, can cause injury. Stop using any tool if discomfort, tingling feeling or pain occurs. You should consult a physician before resuming use of the tool.

! WARNING:

Wear Proper Clothing. During operation of drill attachment, the resulting waste material can be sharp and hot. It can be projected near and far from the operator and can injure bystanders. Wear proper protective clothing such as gloves and long sleeved shirts or jackets to avoid burns and lacerations from flying chips.

Warranty

1. **IMPORTANT:** By using your Rapidrill, LLC (Rapidrill) Product (the “Product”), you (Customer) are agreeing to be bound by the terms of the Rapidrill Limited Lifetime Warranty and Limitation of Liability as set out below.

2. **Do not use your Product until you have read the terms of this warranty.**

3. **If you do not agree to the terms of this Limited Lifetime Warranty or Limitation of Liability, do not use the Product and return it within 30 days of the purchase date for a refund.**

LIMITED LIFETIME WARRANTY

4. Rapidrill warrants that this Product will be free from defects in material and manufacture for the life of the product—no registration or proof of purchase required. This warranty does not cover failures resulting from abuse, misuse, alteration, or damage not caused by Rapidrill, or failure to follow instructions. No warranty is given as to the service life of the Product.

5. **Rapidrill makes no other warranties or conditions, express or implied, including, but not limited to, any implied warranty or condition of merchantability or fitness for a particular purpose or any implied warranty or condition arising out of a course of dealing, customer or usage of trade. In so far as such warranties cannot be disclaimed, Rapidrill limits the duration and remedies of such warranties to the duration of the express limited warranty. Some states (countries and provinces) do not allow limitations on how long an implied warranty (or condition) may last, so the limitation described above may not apply to you.**

6. If the Product fails to satisfy this Limited Lifetime Warranty during the warranty period, Rapidrill will repair or replace the Product at its sole discretion. Customer is responsible for shipping the Product to Rapidrill for warranty claims. Rapidrill will cover the cost of shipping the repaired or replaced Product back to the Customer. The remedy stated in this paragraph is Customer's sole remedy and Rapidrill's exclusive obligation.

7. This warranty gives you specific legal rights, and you may have other rights which may vary from state to state, or country to country. For any warranty questions, please call 855-993-7455 or mail your request to: Warranty Claims, Rapidrill, LLC, 1380 W Uzona Ave, Ste. D, Hildale, UT 84784-2370. Please provide a complete description of the Product, model number, and alleged defect.

INTENDED USE

8. This Rapidrill Product is intended to be used to assist in keeping a drill at a right-angle while drilling. At all times when using the Product, Customer should take reasonable safety precautions, such as, wearing gloves, wearing eye protection, checking surrounding areas and location of drilling, and other safety measures. The Product should not be used from any unstable or unsafe position.

9. Drill Bit Precautions:

Do not exceed 3/4” auger bits.

Do not exceed 2” hole saw bits.

LIMITATION OF LIABILITY

10. **Rapidrill will not be liable for any loss or damage arising from this Rapidrill Product, whether direct, indirect, special, incidental, or consequential, regardless of the legal theory asserted, including warranty, contract, negligence, or strict liability.** Some states and countries do not allow the exclusion or limitation of incidental or consequential damages, so the above limitation or exclusion may not apply to you.

APPLICABLE LAW

11. This Contract shall be governed by and construed under the laws of the State of Utah, excluding its conflict of law rules. The parties agree that the United Nations Convention on Contracts for the International Sale of Goods shall not apply to this agreement.

Package Contents

Every Rapidrill comes fully assembled and is encased in a laser cut soft foam surrounded by a durable plastic case.

In the case you will find:

1. Rapidrill Assembly
 - A. Drill Clamp 1.9"
 - B. Pipe Clamp
 - a. Pipe
2. Drill Clamp 1.7"
3. Hex Wrench 3/16"
4. Hex Wrench 1/4"
5. Warranty Card
6. Documentation (available also at www.rapidrill.com/support)

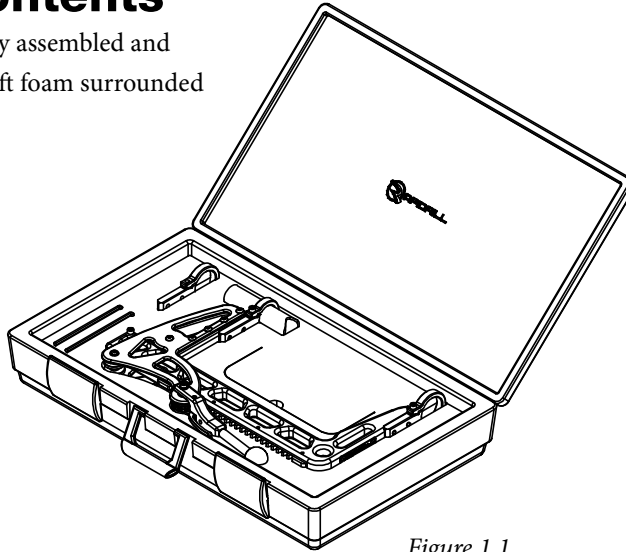

Figure 1.1

For Details see Figure 1.1 (Arrangement of contents may vary.)

Setup

ATTACHING DRILL

1. Rapidrill comes with two sizes of drill clamps to adapt to most standard drill types which are designed for a collar mount auxiliary handle. Models with pincer style mounts are not currently supported.
2. Identify the diameter of the collar on the drill you intend to use. Included drill clamp diameters range two sizes 1.7, and 1.9 inches.
3. Be sure 3/16" hex socket head fastener is loose enough to allow clamp to open wide enough to accept drill collar.
4. Place drill clamp over drill chuck and seat against drill collar on the main drill body.

! WARNING:

Be sure that the correct size of drill clamp is adapted to your drill body. Incredible opposing force must be overcome by maximizing clamping the surface.

5. Pre-tighten fastener on drill clamp to mount drill to the drill clamp. Prepare to mount drill clamp/drill combo to Rapidrill body.

6. Mount the drill clamp to the Rapidrill body using the 1/4" hex socket head fasteners. Typically the drill is mounted on the end opposing the Rapidrill carriage. (See Figure 1.2)

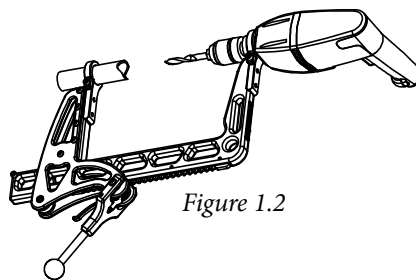

Figure 1.2

Please contact us at 855.993.7455 for further assistance.

7. Determine final drill position relative to the lever of Rapidrill. Operators may prefer right hand or left hand drilling arrangements adapted to particular drilling positions or personal preference. This adjustment is easily accomplished by rotating the drill about the drill clamp collar and finally tightening the hex socket head fastener. (See Figure 1.3)

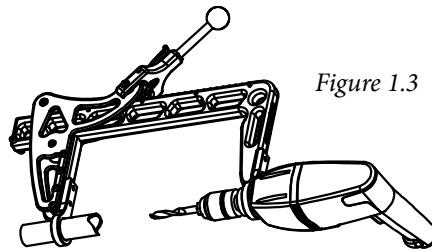

Figure 1.3

8. Attach drill bit to drill chuck. It may be necessary to adjust the Rapidrill carriage by releasing the spring loaded gear dog lever and sliding the carriage to the bottom of the spine.

9. Determine necessary pipe position to clear any obstacles that may prevent perpendicular drilling of the surface to be drilled. Use the 3/16" Hex wrench included. In most cases no adjustment is necessary. (See Figure 1.4)

! WARNING:

Be sure that all clamp fasteners are tightened fully before attempting drilling operations. Failure to adhere could result in parting of the drill from the Rapidrill assembly and/or misalignment of the drill to the surface to be drilled, possibly causing damage to property or personal injury.

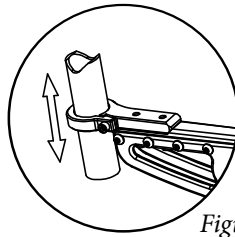

Figure 1.4

NOTE:

The shaped end portion of the pipe is particularly suited for the drilling of a rounded surface such as a pipe. The opposing pipe will self-center when applying initial force, but it may be necessary to create a center punch dent at the point of at which you intend to drill in order to prevent the drill bit from wandering off center point at the beginning of rotation. If you intend to drill a flat surface then the flat of the pipe may be best suited.

Operation

GETTING TO KNOW RAPIDRILL

1. With the setup accomplished, Rapidrill is now only partially ready to perform drilling operations. New users must familiarize themselves with the operation of the tool.

2. Rapidrill is a unique tool which utilizes the rotary power of a cordless or corded drill and your physical strength to rapidly perform drilling operations which otherwise would require much greater physical prowess and skill. With some training, an operator can safely perform drilling tasks quickly, greatly reducing operator fatigue and extending drill bit life.

3. The rotary torque of the drill will now be closely matched to the operators physical pull power. The operator must find the balance of torque and pull power while drilling, as the drill's power of rotation can be overcome or reduced, limiting the functionality of the operation.

4. The operator must also realize the force applied at the lever must be regulated during the final portion of penetration in order to reduce the possibility of the drill bit binding. Although, with the operator stance facilitated by the design of Rapidrill, the backlash of a drill with a binding bit will be more fully controlled.

5. With these precautions in mind, the new operator may proceed by gripping the drill handle and the Rapidrill lever.

6. By gripping the drill with the dominant hand and slipping the hand holding the Rapidrill lever from the ball end toward the spine and carriage body, the back of the fingers will come in contact with the spring loaded gear dog lever. This contact will simultaneously release the gear dog from the gear and allow the release and travel of the carriage along the spine. (See Figure 2.0)

7. While in this release position, the operator can open the Rapidrill fully and position it over the workpiece.

8. Once positioned over the workpiece, the gear dog should be allowed to spring back into the gear.

9. Rotate the lever away from the operator to begin the workpiece engagement. (See Figure 2.1)

10. While rotating the lever away, as the gear dog is engaged, the operator must pull the carriage assembly to clamp the workpiece between the pipe and the drill bit.

11. Upon placement of drill bit at desired drilling location, grip the ball end of the lever and apply initial force to initiate perpendicular alignment of the drill bit to the workpiece.

12. Place your body at a comfortable stance for the duration of the drilling operation.

13. The user may actuate the drill and apply gentle force to begin the drilling operation. (See Figure 2.2)

Figure 2.0

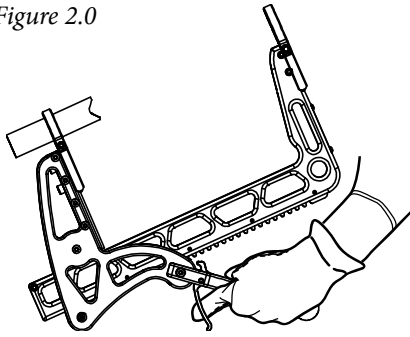

Figure 2.1

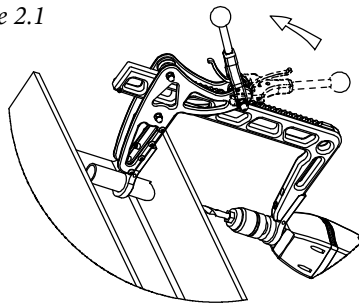
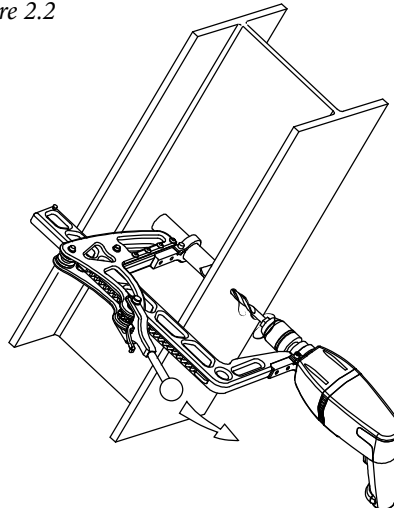

Figure 2.2



14. Using judgment attained from the descriptions beforehand, the user may complete the operation safely.

15. Once the workpiece has been drilled, and maintaining grip of the drill, the hand holding the lever may again slide down toward the spine and carriage, the back of the fingers thereby coming into contact with the gear dog lever and release the gear dog from the gear, allowing the carriage to travel open.

16. Pull the drill bit back out of the drilled hole and move the Rapidrill to the next drilling position to repeat.

! WARNING:

Users must maintain grip of the drill handle and Rapidrill lever in order to control backlash. Failure to maintain control could result in personal injury.

NOTE:

One lever rotation equals 1 inch of travel through the workpiece. On materials thicker than 1 inch, after reaching this limit, the operator must first rotate the lever back to the beginning engagement position, pull the carriage forward to re-engage the workpiece, assure the re-engagement of the gear dog, and pull the lever to continue the drilling operation.

NOTE:

If the desired drilling location does not accommodate the default arrangement of the drill attached to the spine opposing the carriage pipe, the user may reverse this position, mounting the drill to oppose the end of the pipe mounted to the spine, thus compacting the size of the Rapidrill assembly. The user must also familiarize their self with the opposite motion of the lever and actuation of the gear dog lever in this position.

(see figure 2.3)

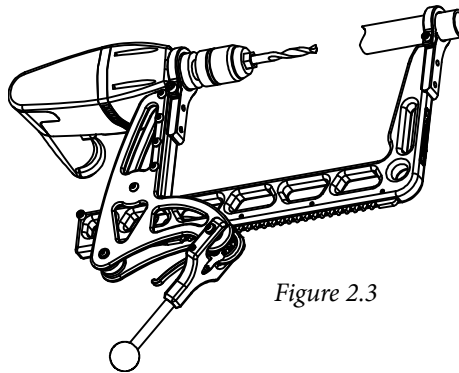

Figure 2.3

CAUTION:

Operating any power tool can result in foreign objects being thrown into your eyes, which can result in severe eye damage. Before beginning operation, always wear safety goggles, safety glasses with side shields or a full face shield when needed.

Always use eye protection marked to comply with ANSI Z87.1.

Maintenance

Rapidrill's finish comprises of hard coat anodizing of the aluminum components and zinc phosphate coating of the steel pipe and clamps.

ANODIZED COATING

The anodized coating is particularly suited for smooth sliding of mating components as well as protecting Rapidrill from corrosion. According to frequency of use, it may be necessary to apply a dry lubricant such as graphite or Teflon powder to ease the friction between the carriage and the spine, as well as the captive rollers, axles and pivot points of the tool. To keep unwanted surface damage to a minimum, remove sand, dirt and residual metal particles between drilling cycles.

ZINC-PHOSPHATE COATING

The zinc phosphate coating facilitates a rough surface to limit the possible slipping of the drill and pipe surfaces during drilling operations. The porous coating allows oil to penetrate thereby preventing corrosion. This surface can deteriorate by abrasion and should be maintained as well as possible to extend productive life. Any light oil or silicone may be used to enhance the resistance to corrosion.

OTHER COMPONENTS

The various sub-component hardware items are comprised of stainless steel, brass, and oil embedded brass bushings to further enhance the durability of this product. With the exception of the clamp fasteners, these components should need little attention besides the occasional application of the dry lubricant and removal of sand, dirt and residual metal particles between drilling cycles. The clamp fasteners are Grade 8 with a black oxide coating, which is best suited to accept the stress of repeated tightenings. These items may be left as is until replacement is necessary from average wear and tear.

Incidental surface wear or damage may occur during the normal life of the product. In most cases it will not alter the usability of the product. Exercise care and take reasonable precautions to avoid unnecessary repairs. Refer to warranty disclosure for further details and information.

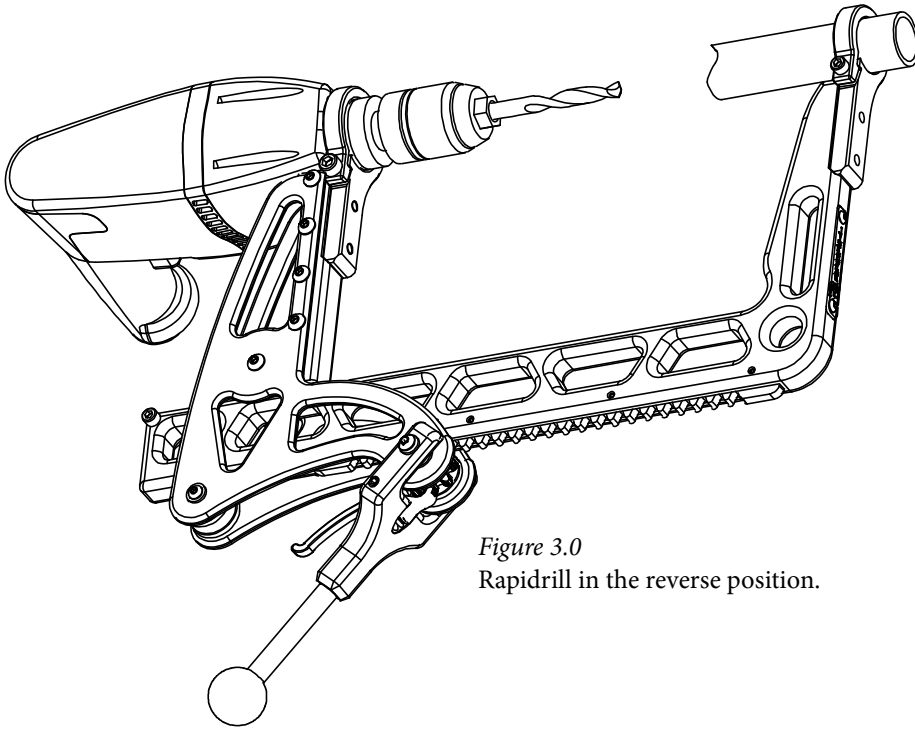
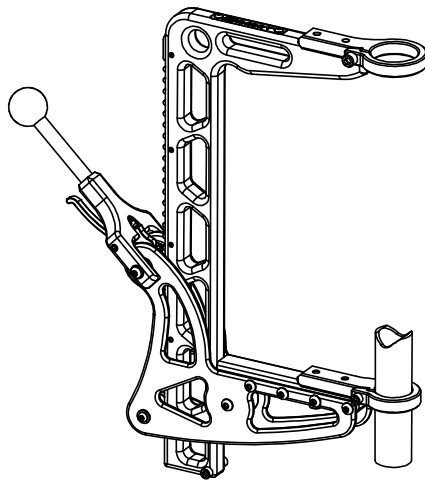

Figure 3.0
Rapidrill in the reverse position.





[illegible]

15



Rapidrill, LLC
1233 S Old Hwy 91
Kanarrville, UT 84742

P 855.993.7455
F 855.631.0769
www.rapidrill.com
support@rapidrill.com

-  www.youtube.com/rapidrill
-  www.facebook.com/rapidrill
-  www.twitter.com/rapidrill
-  plus.google.com/+rapidrill

