

## RHINO CART® (Part No. TD5-6030Q-F1)

### Contents:

- Specifications
- Parts List
- Quick Guides
- Maintenance
- Safety
- Limited Warranty

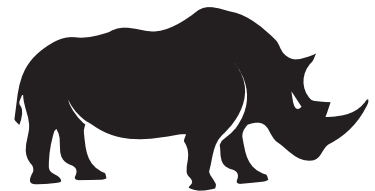

StrongHandTools

**RHINO CART®**  
MOBILE FIXTURING STATION

*Charge right through your most  
challenging projects!*

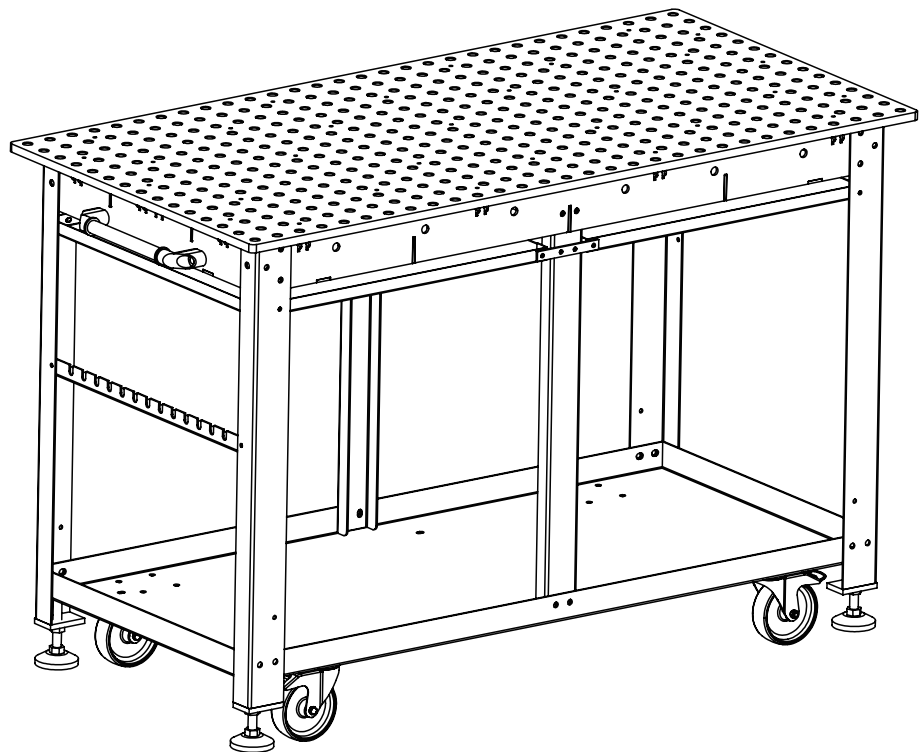
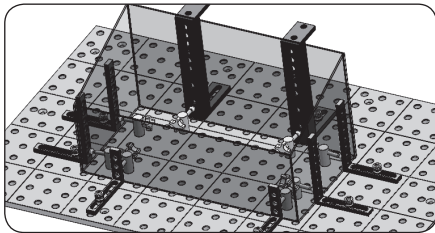
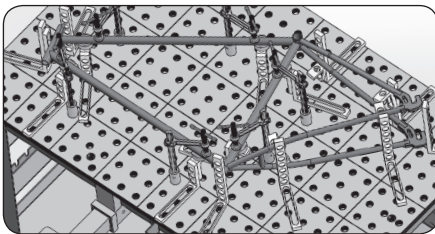
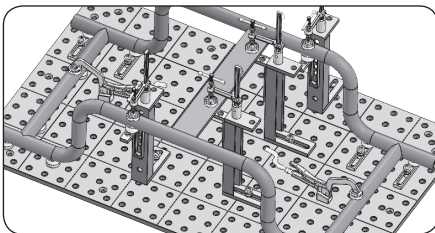
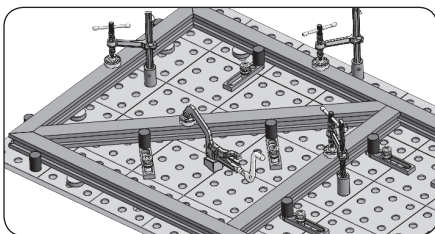

### Specifications:

Part No.	Tabletop Size	Tabletop Thickness	Hole Diameter	Grid Pattern	Table Height	Table weight
TD5-6030Q-F1	60" x 30"	0.63"	0.625"	2" x 2"	40"	540 LBS

# PARTS LIST



PN: TD5-6030Q-F1  
RHINO CART®

Carefully unpack all parts and components and compare to the Parts List inventory below.

No.	Item	Qty	No.	Item	Qty
A	Tabletop and Frame Assembly	1	Q1	Button Head Screws M10 x 16	40
B	Stand Columns	2	Q2	Button Head Screws M10 x 20	16
C	Connecting Plates	2	Q3	Socket Head Cap Screws M10 x 30	2
D	Slag Trays	2	Q4	Plug Screws 6.5 x 10 x M5	4
E	Lower Tray	1	Q5	Button Head Screws M6 x 16	2
F	Tool Hanger	1	R1	Hex Jam Nuts M10	40
H	Handle	1	R2	Hex Lock Nuts M10	16
J1	Casters (swiveling) with locking brake	2	R3	Hex Nuts M10	2
J2	Casters (fixed)	2	R4	Hex Nuts M5	4
L1	Legs (left)	2	R5	Hex Nuts M6	2
L2	Legs (right)	2	S	Washers	16
P	Leveling Pads	4			

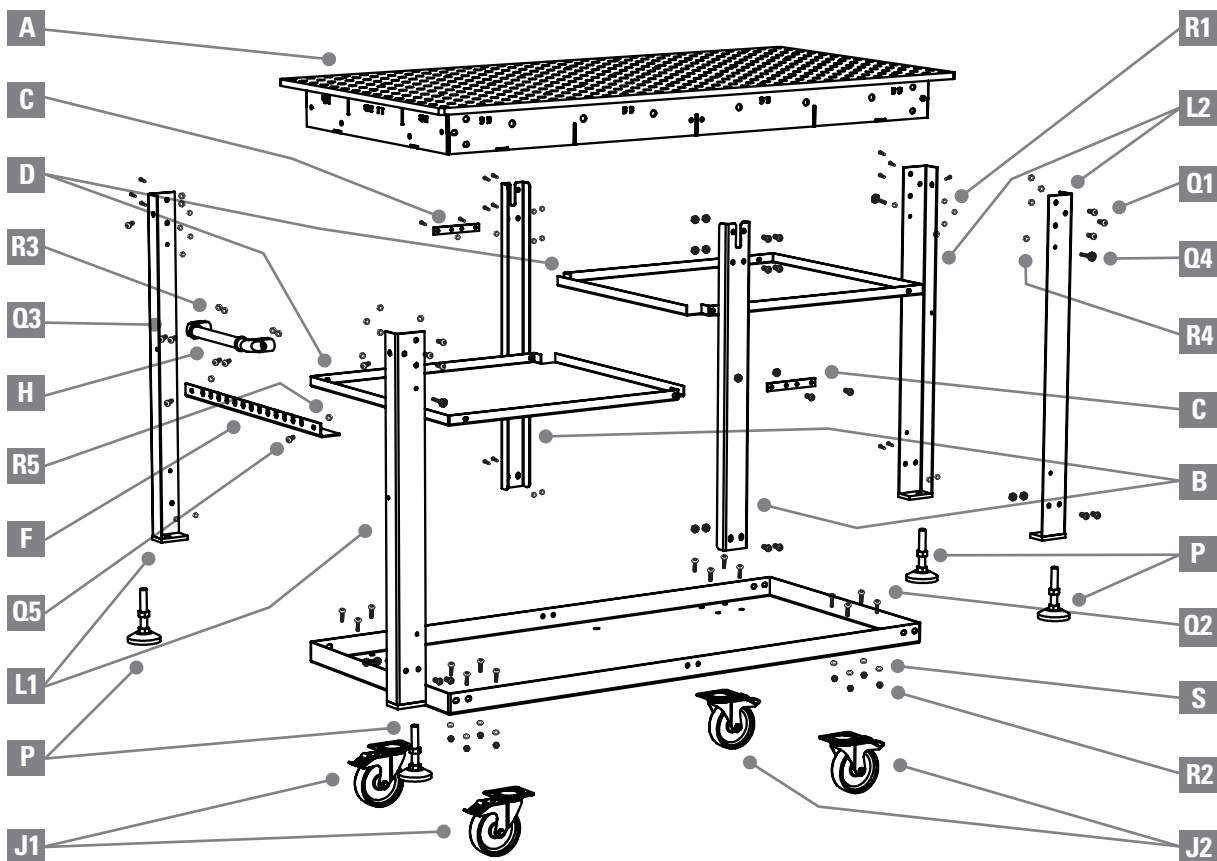

Please note that the Rhino Cart comes pre-assembled for your convenience. However, we strongly recommend that you carefully check all components to ensure that they are properly locked and tightened before use. Even though the cart is pre-assembled, it is possible that some components may have shifted during shipping or handling. This precaution will help ensure safe and trouble-free operation of the Rhino Cart.



To quickly lock/unlock the slag trays underneath the table, follow these steps:

1. Locate the plunger on both sides of the table.
2. Lift the slag tray up in place and pull the plunger outwards to adjust.
3. Once the slag tray is securely in place, release the plunger to lock.
4. Repeat the same process on the other side to ensure both slag trays are securely locked in place.

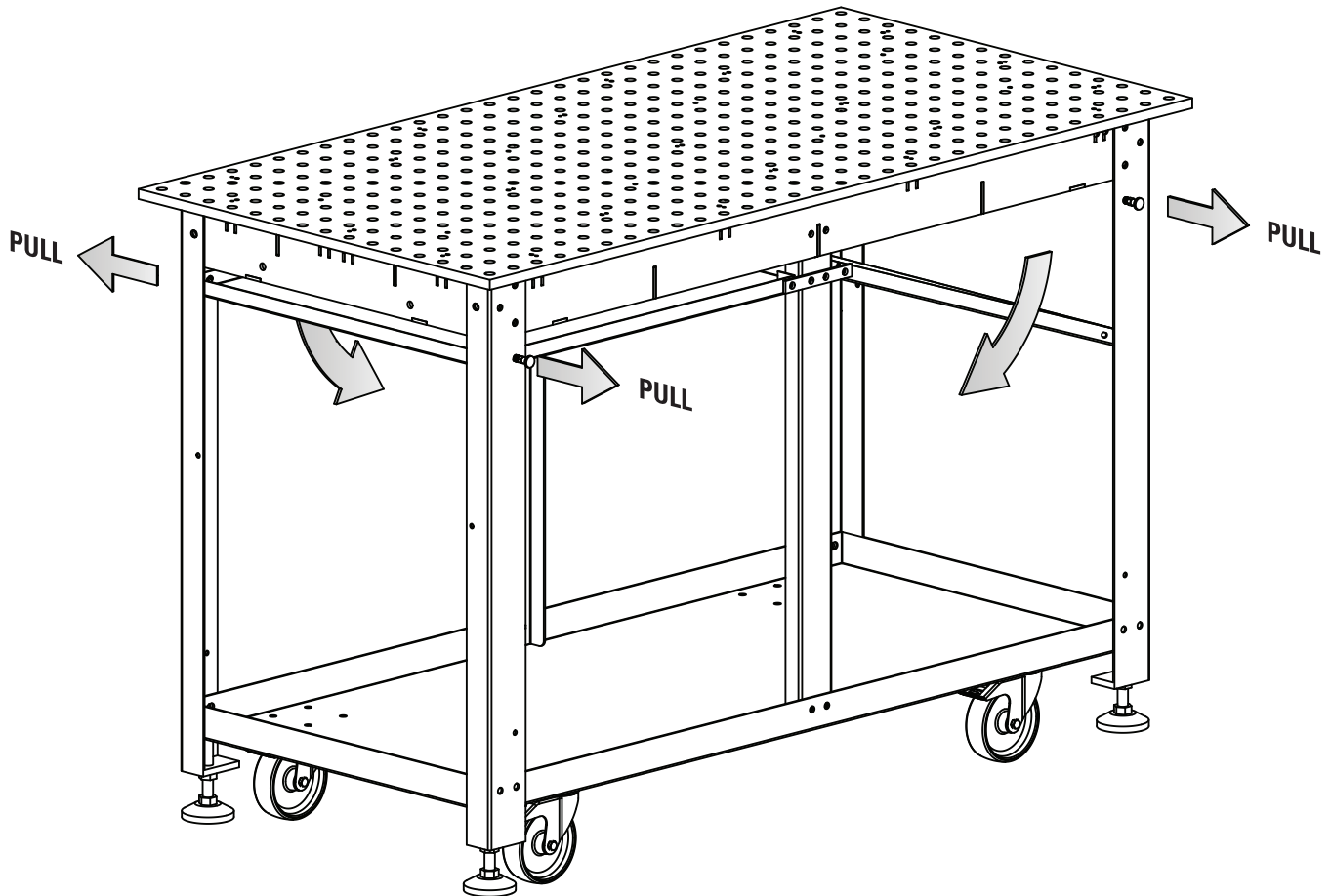

## Maintenance

Keep the cart clean for optimal performance. Wipe away dust and debris from the tabletop and legs.

## Safety

ALWAYS wear safety goggles, gloves, and other appropriate safety items for protection. Use the cart only for its intended purpose. NEVER stand on the cart. Do not drop the cart, throw it, or otherwise misuse the cart.

## Limited Warranty

Each STRONG HAND TOOL® product is warranted to be free from defects in material and workmanship. Return to place of purchase for a replacement if warranty applies.

Distributed by: **Trick-Tools.com**

Trick-Tools  
75 Truman Road  
Pella, IA 50219

Phone: 1-877-VAN-SANT  
E-mail: [sales@trick-tools.com](mailto:sales@trick-tools.com)

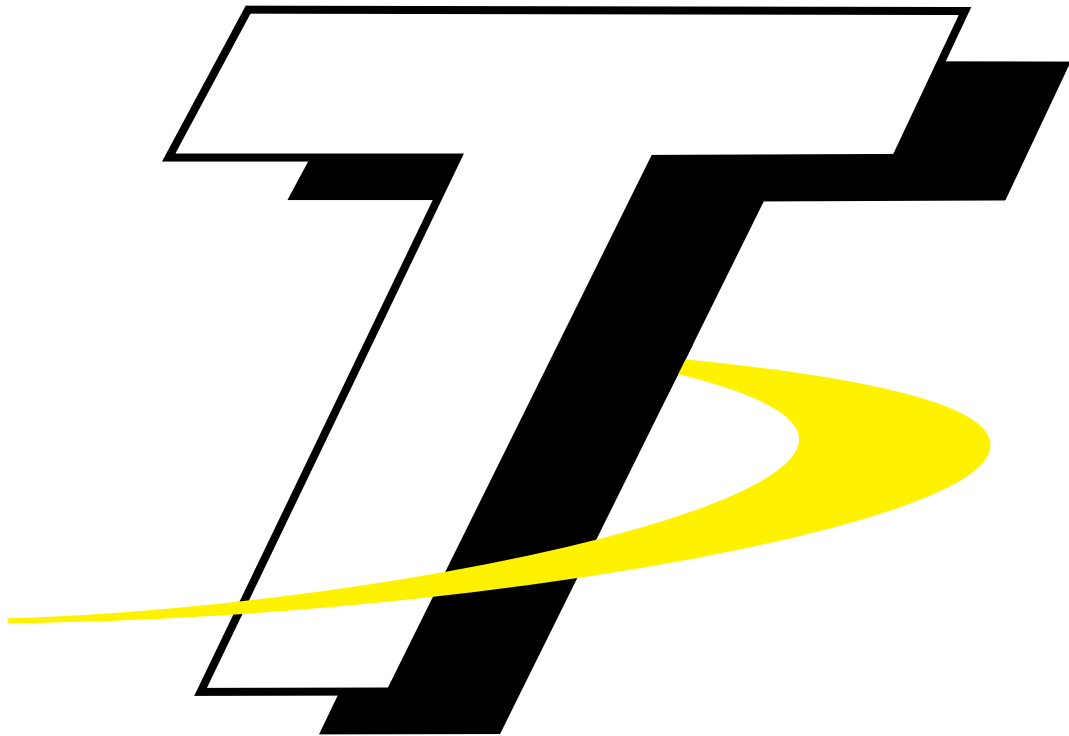

Here at Trick Tools we believe that our customers deserve the best value in their tool and equipment purchases. We are constantly at work searching out a variety of high quality, high performance tools to offer at the best prices possible. Our commitment to you is that we will not offer "cheap junk" anywhere on our website. You, the customer, help us to evaluate our products constantly and as soon as an ongoing quality issue is uncovered we will correct it or discontinue that product immediately. We hope to earn your continued trust.